



**AZTECH CONVERTING SYSTEMS**

212 W Lodge Drive

TEMPE, AZ 85283

PHONE (480) 951-8351

FAX (480) 998-5409

[www.aztechconverting.com](http://www.aztechconverting.com)

# Pal-A-Tilt PT-2000 / PT-3000 User Manual

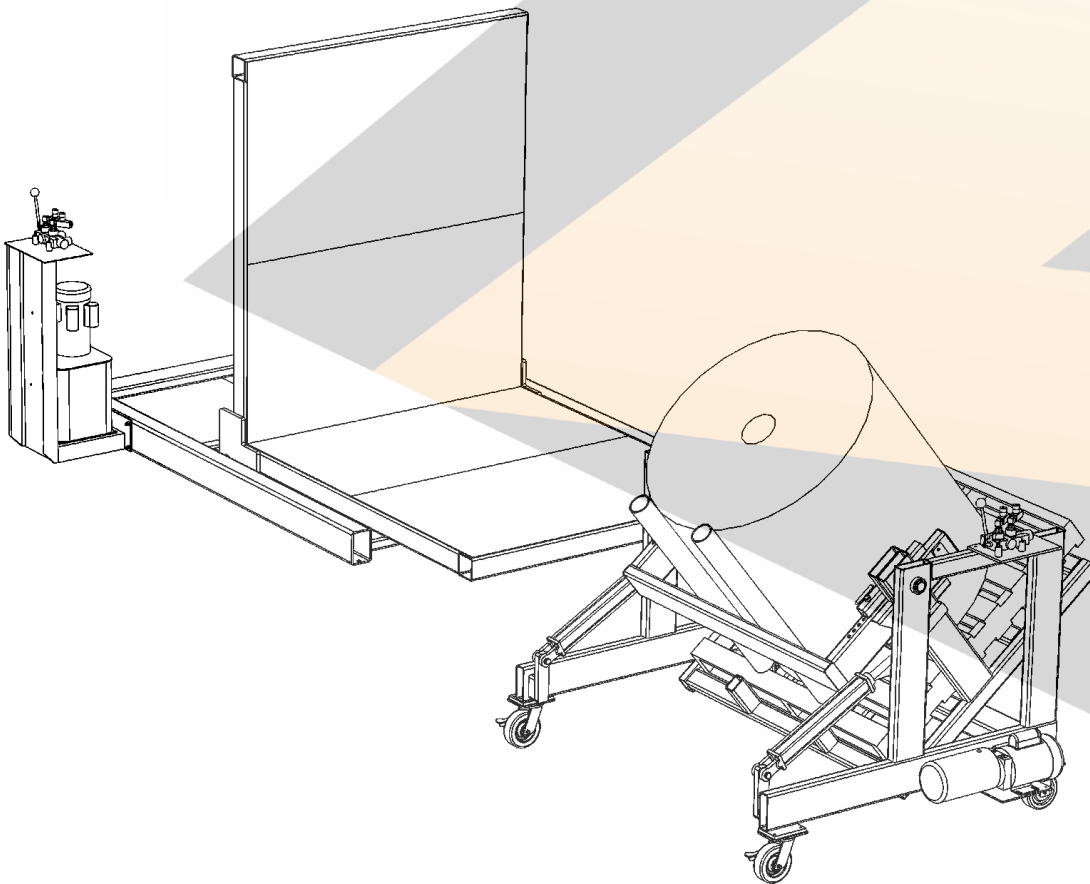



# **AZTECH CONVERTING SYSTEMS**

**PT-2000  
USER MANUAL**

---

## **TABLE OF CONTENTS**

<b>SECTION 1: GENERAL INFORMATION</b>	<b>1-3</b>
<b>SECTION 2: MACHINE INSTALLATION</b>	<b>4</b>
<b>SECTION 3: MACHINE OPERATION</b>	<b>4-6</b>
<b>SECTION 4: GENERAL MAINTENANCE</b>	<b>7</b>
<b>SECTION 5: MACHINE DETIALS</b>	<b>11</b>
<b>SECTION 6: WARRENTY AND SERVICE</b>	<b>12</b>



## Section 1: General Information

### 1-1: Introduction

The AZTech Pal-A-Tilt Series Models are designed and manufactured to help reduce workplace injuries by allowing you to tilt a vertical roll or stack of rolls 90 degrees into the workable upright position. AZTech's pallet tilters with their all-steel construction and simplistic design will prove to be an invaluable product for your work environment and is sure to provide your company many years of safe and dependable service.

### 1-2: Safety

It is critical that people stay clear of the load as it is tilting, as the load may be unstable, and that it is never used to transport people or exceed the model's load limitation.



# AZTECH CONVERTING SYSTEMS

## PT-2000 USER MANUAL

### 1-3: Machine Information and Specifications

#### PT-2000 Dimensions

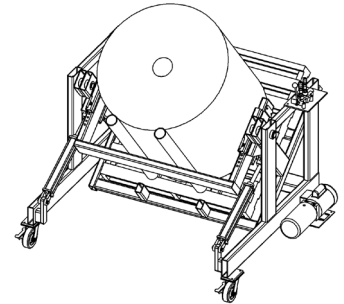
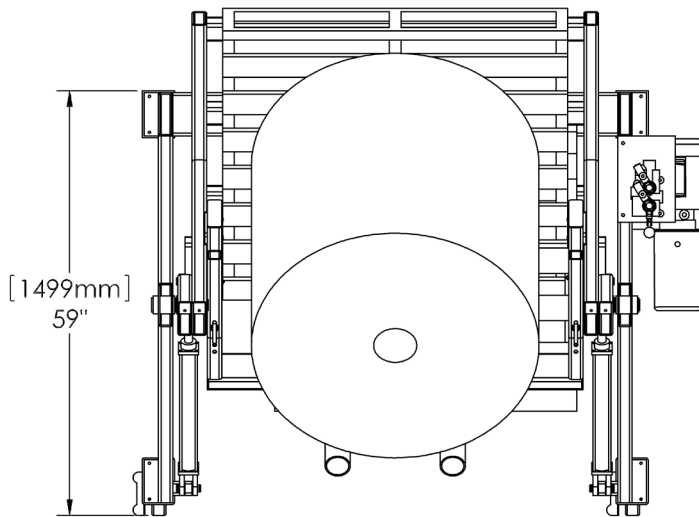

Maximum Tilt Weight : 2000 lbs. (905 kg)

Dimensions: Width : 48" (122 cm)

Depth : 64" (162 cm)

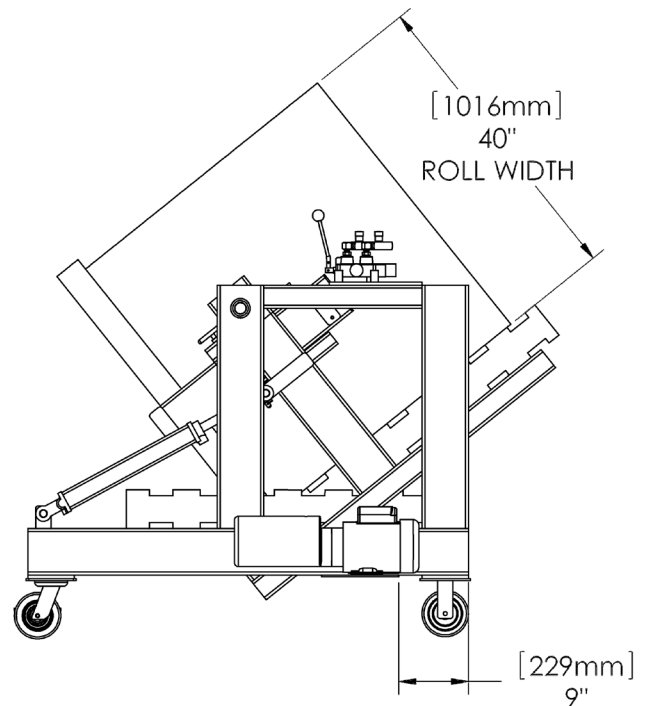
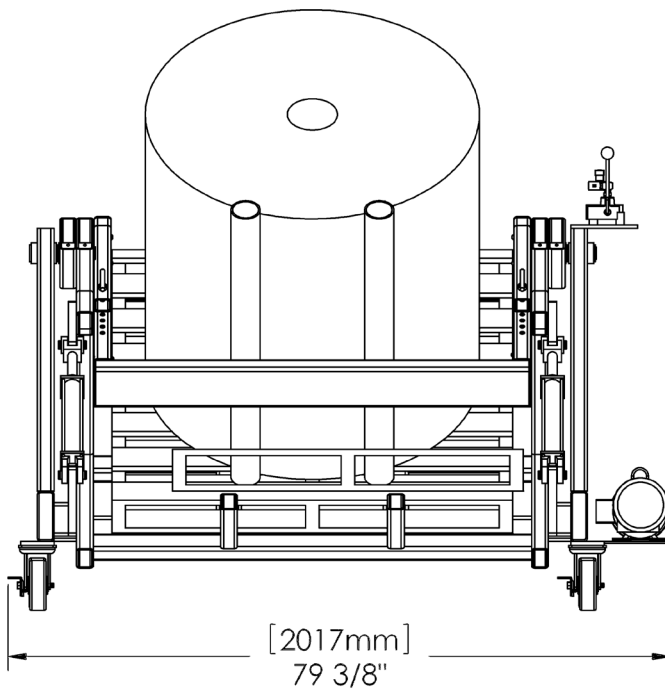

# AZTECH CONVERTING SYSTEMS

PT-2000  
USER MANUAL



## PT-3000 Dimensions

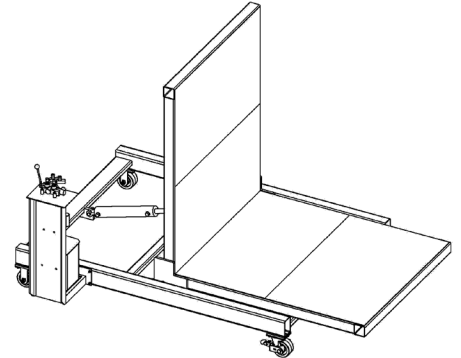
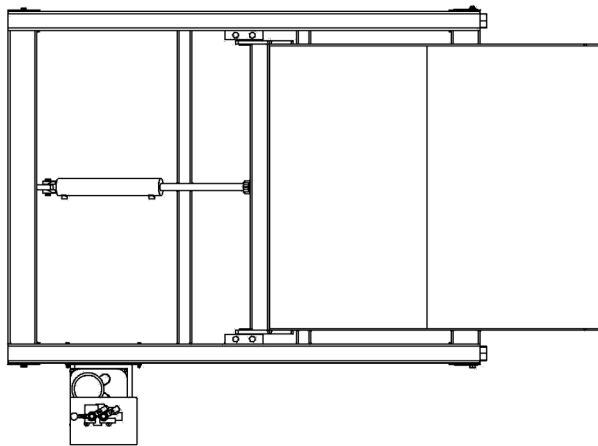

Maximum Tilt Weight : 3000 lbs. (1357 kg)

Dimensions: Width : 91" (231 cm)

Depth : 125" (318 cm)

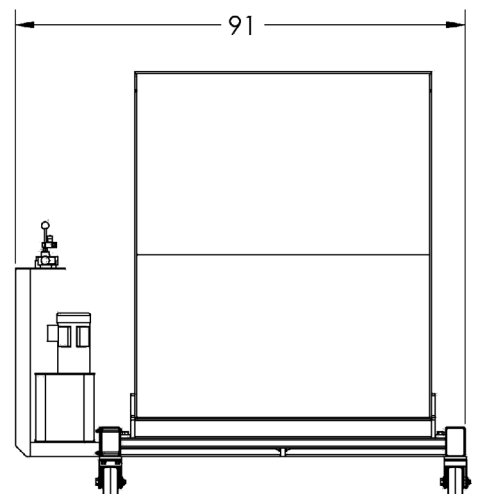
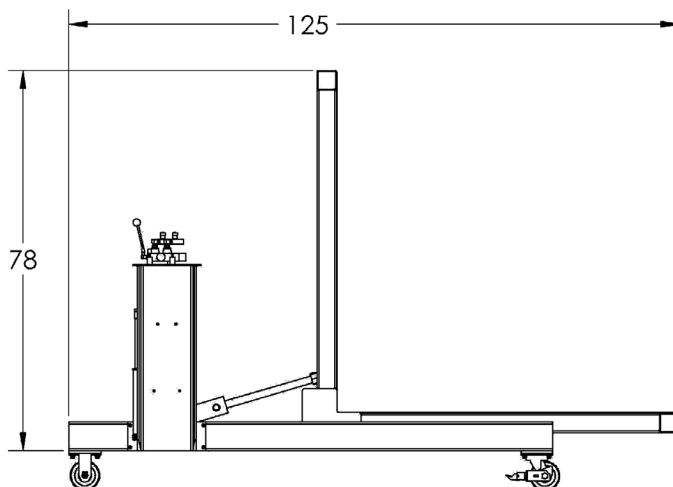

*Shown with optional casters.*



# AZTECH CONVERTING SYSTEMS

## PT-2000 USER MANUAL

### Section 2: Machine Installation

#### 2-1: Un-Crating and Inspection

After carefully removing the Pal-A-Tilt from the crate, check to assure that all fittings are tight and that nothing has come loose during shipment. Inspect for hydraulic fluid leakage. If equipped with wheels, carefully inspect all 4 wheels making sure they roll freely and are free of damage. If any visible damage has occurred in shipment, contact AzTech Converting Systems immediately.

#### 2-2: Set-Up

Fill the hydraulic reservoir and check for leaks. The Pal-A-Tilt requires either a 110 or 220 volt single-phase A/C power supply, specified at time of order.

### Section 3: Machine Operation

#### 3-1: Connecting to A/C Power Outlet

The Pal-A-Tilt is equipped with a hydraulic pump that requires either 110 or 220 volt single phase electricity. To connect, plug the Pal-A-Tilt into either a 110 volt 20 amp, or 220 volt 10 amp receptacle.

#### 3-2: Positioning & Locking Wheels (If Equipped)

If your Pal-A-Tilt is equipped with optional swivel wheels, you may move it to a level position of your choice, making sure to lock all 4 wheels by pressing down on the toe-brakes.

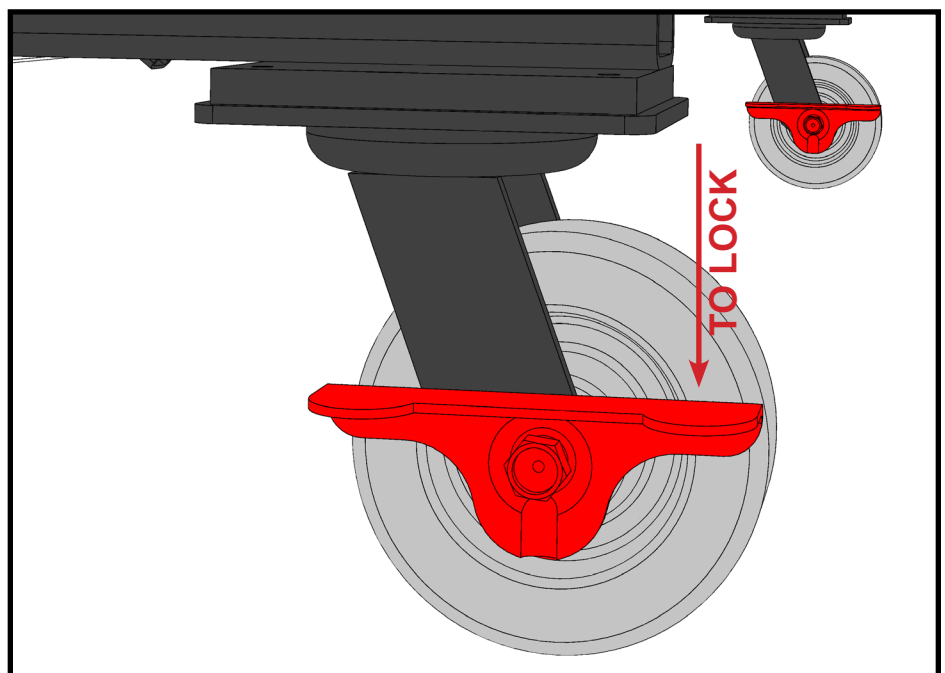



### 3-3: Setting Pallet Load onto Platform

With platform in the horizontal position, set desired pallet load onto the horizontal platform with a forklift, centering it from side to side flush against the two support bars.

### 3-4: Rotating the Load

To operate the hydraulic tilt, press and hold button, move lever counter-clockwise (left) to rotate load counter-clockwise, and clockwise (right) to rotate load clockwise. Once the Pal-A-Tilt has turned a full 90 degrees, it will shut off automatically.

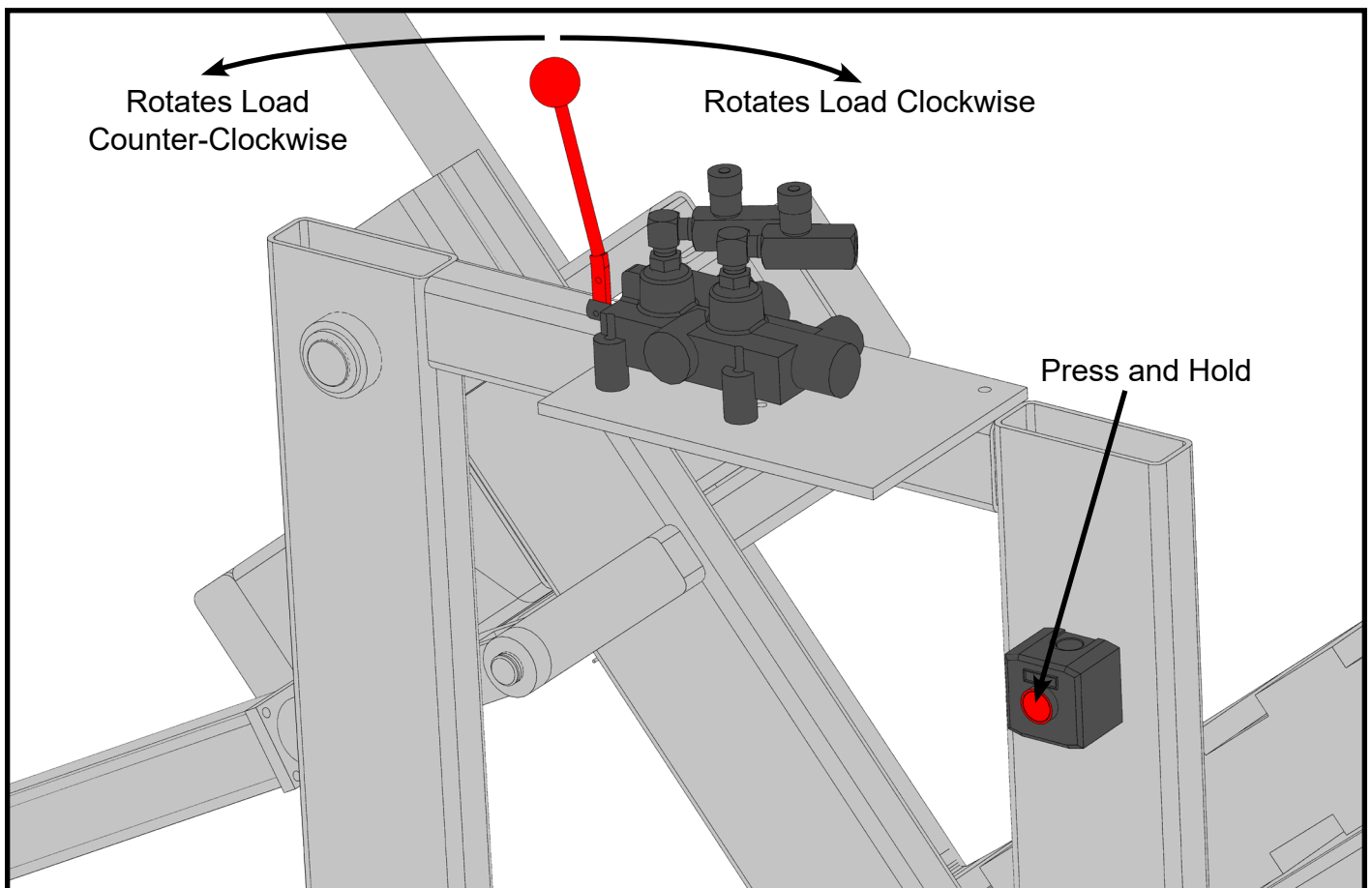



# AZTECH CONVERTING SYSTEMS

## PT-2000 USER MANUAL

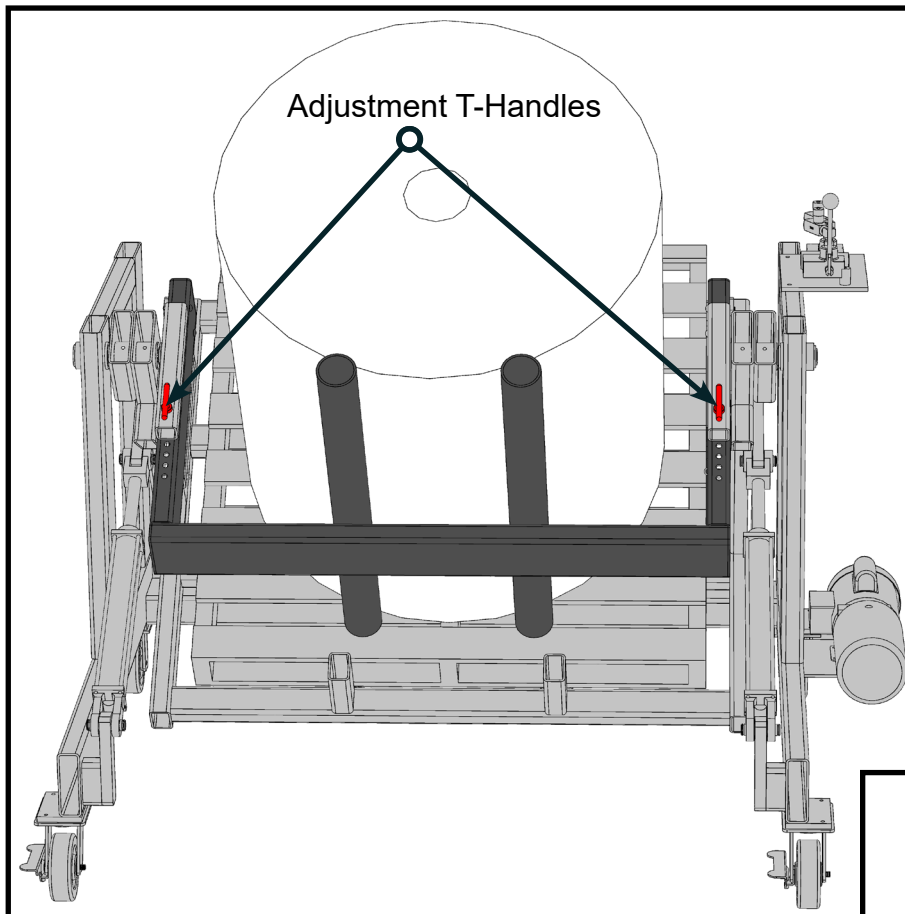

### 3-5: Adjusting Platform

The Pal-A-Tilt PT-2000 is equipped with an adjustable platform. To adjust length, remove both T-Handle retainer pins on bottom side, pull out T-Handles, place T-Handles into desired holes and replace retaining pins on bottom side.

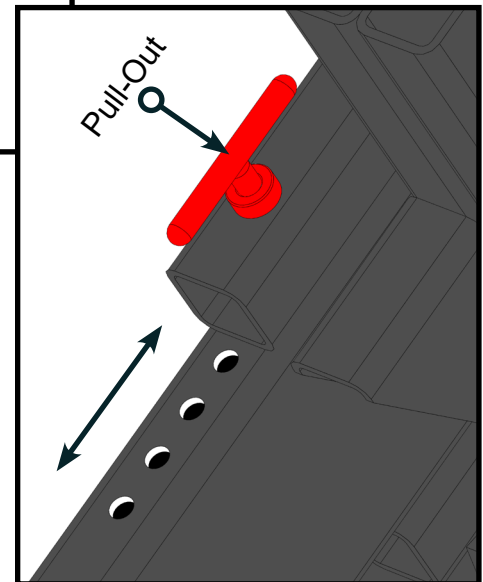





## Section 4: General Maintenance

### 4-1: Periodic Inspection & Maintenance

The Pal-A-Tilt's hydraulic pump utilizes hydraulic fluid which needs to be checked periodically to make sure the reservoir is adequately filled. Periodically inspect cylinders, hoses, and fittings for fluid leaks. If any leaks are present, have them repaired immediately, or contact AzTech's Service Department for assistance.

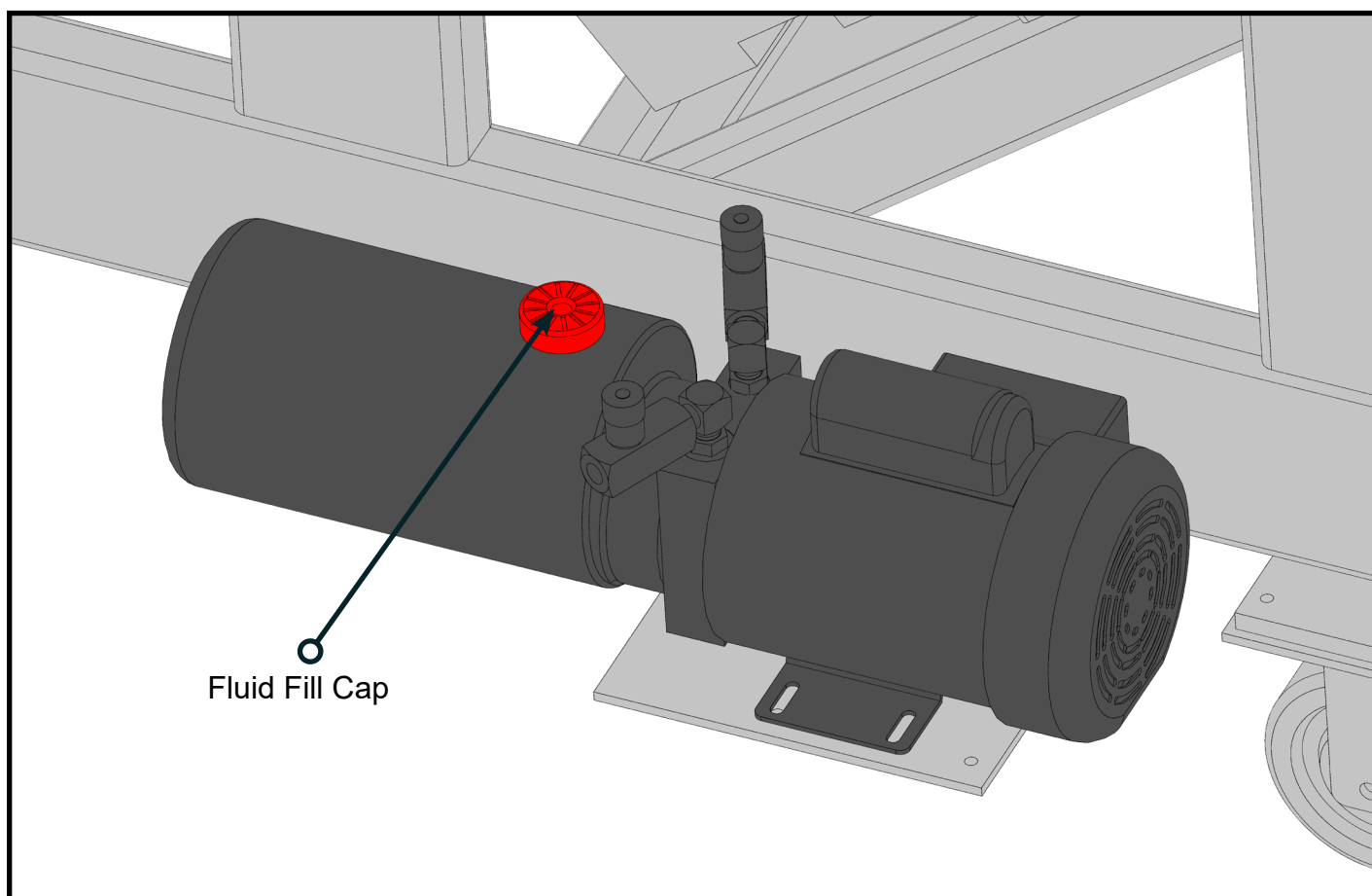

PT-2000 Shown



# AZTECH CONVERTING SYSTEMS

## PT-2000 USER MANUAL

### Section 5: Machine Details

#### 5-1-1: PT-2000 Assembly

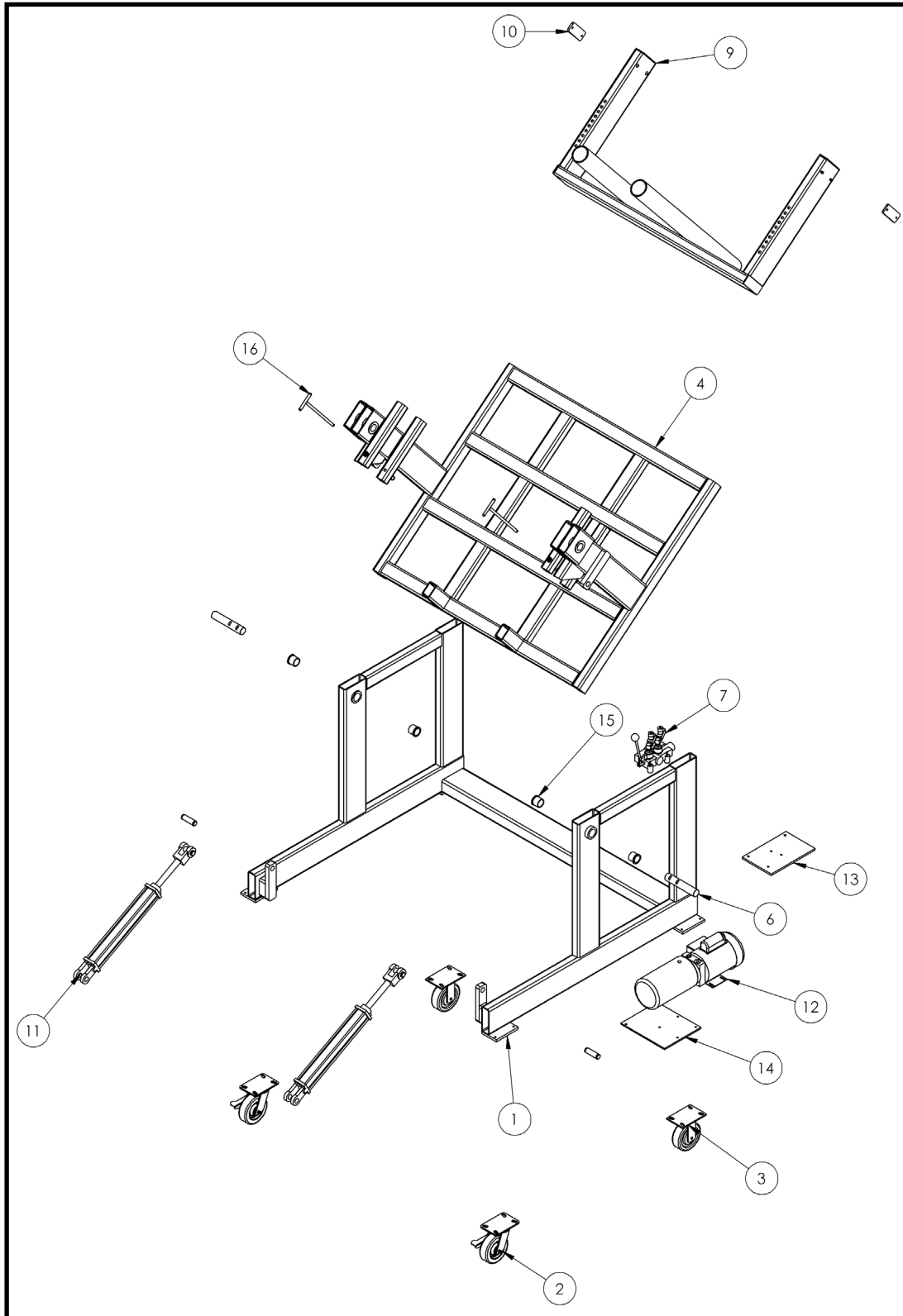

# AZTECH CONVERTING SYSTEMS

## PT-2000 USER MANUAL



### Electrical Schematic (Mail Lift)

ITEM NO.	PART NUMBER	DESCRIPTION	Default/ QTY.
1	13679	PALLET TILTER PORTABLE FLOOR WELDMENT	1
2	CAS009-834 CASTER ASSEMBLY		2
3	012-400 CASTER FIXED	NAME	2
4	13686	PALLET TILTER PORTABLE CRADDLE WELDMENT	1
5	13685 ROLL	NAME	1
6	13886	PALLET TILTER PORTABLE PIVOT SHAFT	2
7	13495 ASSEMBLY	PRINCE LOG SPLITTER DETENT VALVE	1
8	Pallet 48 x 48	48" WIDE x 40" DEEP x 5.5" HIGH PALLET	1
9	15444	NAME	1
10	15449	PALLET TILTER PORTABLE CRADDLE END CAP THREADED	2
11	992004	Tie Rod Hydraulic Cylinder — 2in. Bore, 16in. Stroke	2
12	105871 POWER UNIT	1 HP 115/220 1725 RPM MOTOR	1
13	13670	AUTOMATIC ROLL LIFT VALVE PLATE	1
14	13650-A	CMU ROLL LOAD PUMP MOUNT PLATE	1
15	6338K442	1-1/2 X 1-3/4 X 1-1/2 FLANGED BEARING	4
16	15574	PT-2000 PAL-A-TILT RELEASE PIN ASSEMBLY	2
17	BTNHD_~375-16 UNC_2~5_SIMP	BUTTON HEAD CAP SCREW 3/8-16 X 2-1/2"	4

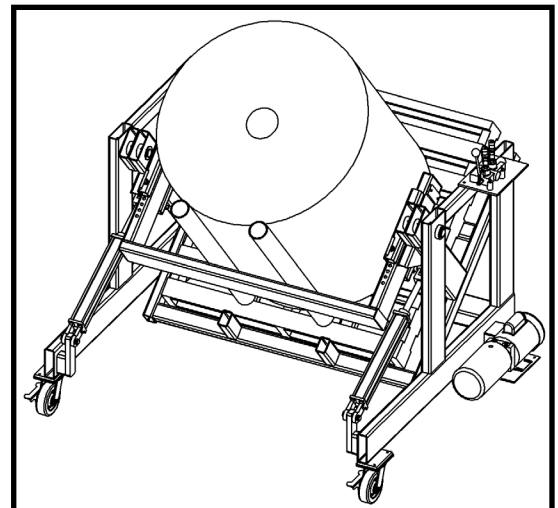



# AZTECH CONVERTING SYSTEMS

## PT-2000 USER MANUAL

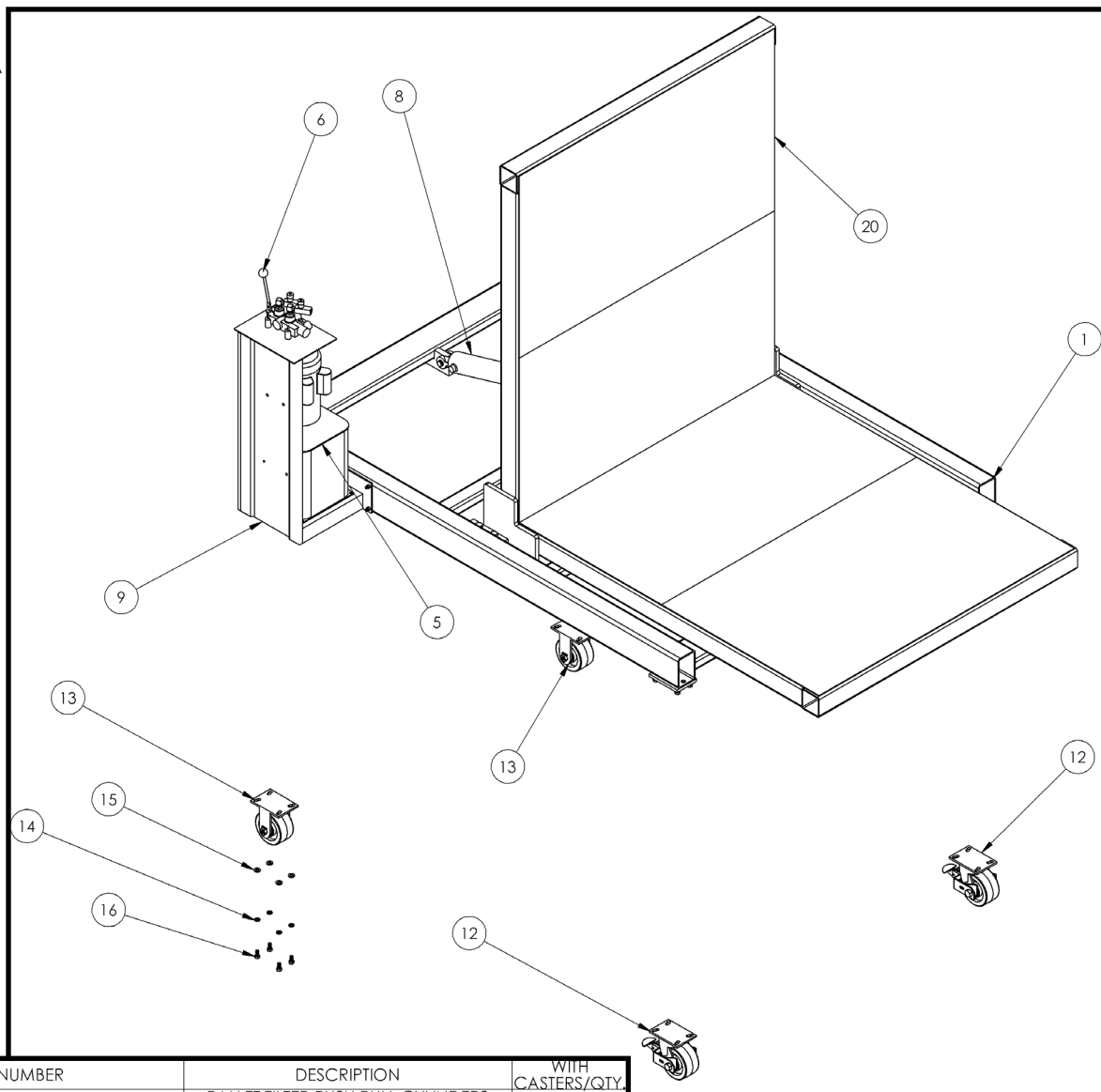

*Shown with optional casters.*

ITEM NO.	PART NUMBER	DESCRIPTION	WITH CASTERS/ QTY.
1	14616	PALLET TILTER PUSH PULL CYLINDERS	1
2	14623	BASE FLOOR ASSEMBLY	2
3	HEX BOLT GRADE 8_~750-10 UNC_3~5_SIMP	PALLET TILTER PUSH PULL BUSHING	4
4	DWL PIN GRD_~50000_1	BLOCK TOP	4
5	HYDRAULIC PUMP 10591	1/2 DIA X 1 LONG DOWEL PIN	1
6	13495 ASSEMBLY	Haldex AC Hydraulic Power System Self-Contained, 2 HP, 115/230V AC	1
7	644825 CYLINDER ASSEMBLY	PRINCE LOG SPLITTER DETENT VALVE	1
8	644825 CYLINDER ASSEMBLY	3000 PSI 3" BORE X 18" STROKE, DOUBLE ACTING	1
9	14663	3000 PSI 3" BORE X 18" STROKE, DOUBLE ACTING	1
10	HEX NUT_~375-16 UNC_0_LOCK	PALLET TILTER PUSH PULL CONTROL PANEL WELDMENT	6
11	HEX BOLT_~375-16 UNC_5_SIMP	NYLOCK NUT 3/8-16	4
12	CAS030-033 SWIVEL ASSEMBLY	HEX BOLT 3/8-16 X 5" GRADE 5	2
13	CAS017-815 ASSEMBLY	Swivel 6x3 2000lb Height 7.5in.	2
14	WSHR A_~500 LOCK	NAME	8
15	WSHR A_~500 HARD	1/2 LOCK WASHER	8
16	HEX BOLT_~500-13 UNC_1_SIMP	HARD FLAT WASHER 1/2"	8
17	WSHR A_~375N	HEX BOLT 1/2-13 X 1"	2
18	HEX BOLT_~375-16 UNC_1_SIMP	WASHER 3/8 N	2
19	14764	HEX BOLT 3/8-16 X 1"	2
20	14766	PALLET TILTER PUSH PULL, PIVOT BUSHING	1
		PALLET TILTER PUSH PULL CYLINDERS TILT PLATFORM 60 BY 70"	

# AZTECH CONVERTING SYSTEMS

## PT-2000 USER MANUAL



### 5-1-2: PT-3000 Assembly

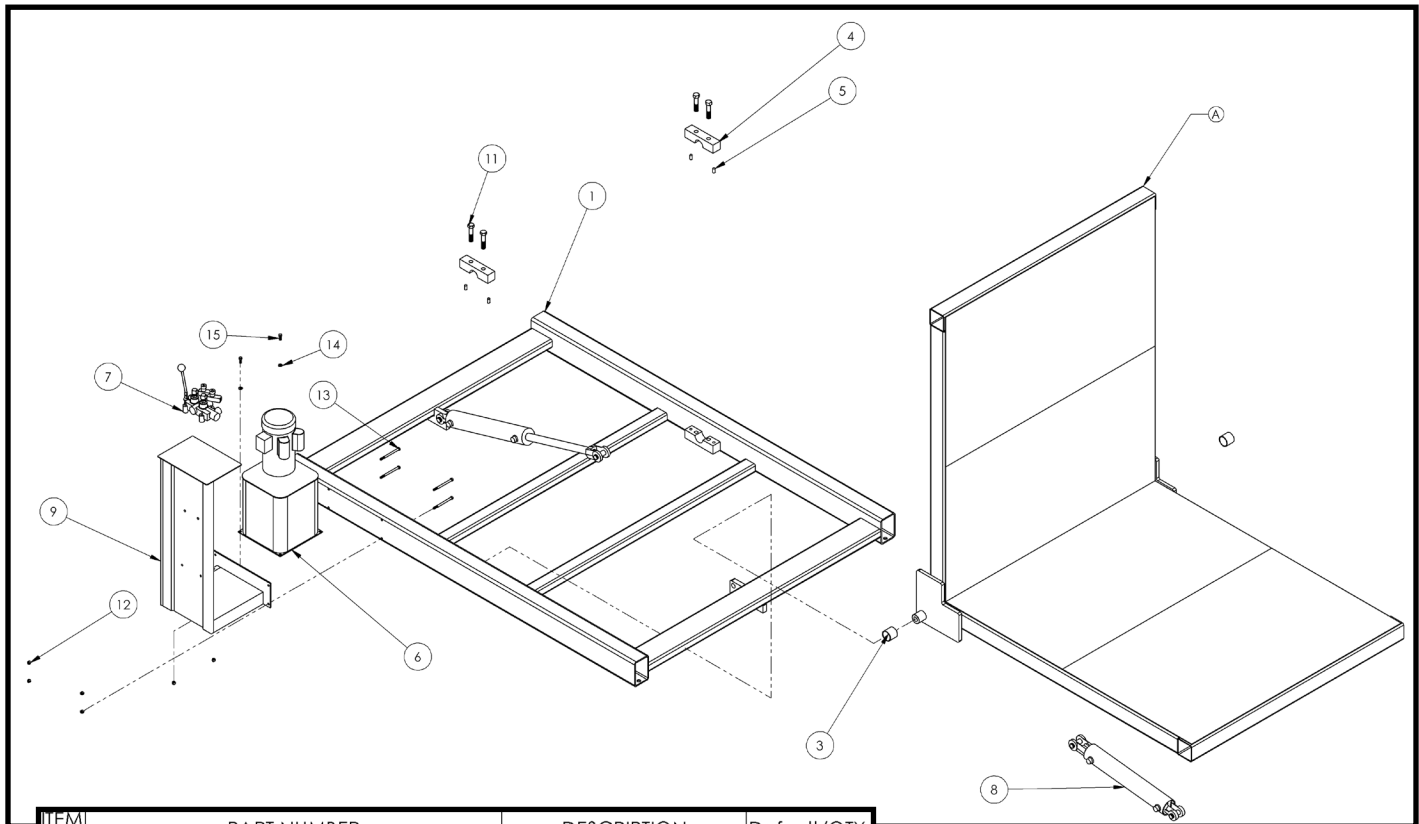

ITEM NO.	PART NUMBER	DESCRIPTION	Default/QTY.
1	14616	PALLET TILTER PUSH PULL CYLINDERS BASE FLOOR ASSEMBLY	1
2	14766	PALLET TILTER PUSH PULL CYLINDERS TILT PLATFORM 60 BY 70"	1
3	14764	PALLET TILTER PUSH PULL PIVOT BUSHING	2
4	14623	PALLET TILTER PUSH PULL BUSHING BLOCK TOP	2
5	DWL PIN GRD_-50000_1	1/2 DIA X 1 LONG DOWEL PIN	4
6	HYDRAULIC PUMP 10591	Hallex AC Hydraulic Power System Self-Contained, 2 HP, 115/230V AC	1
7	13495 ASSEMBLY	PRINCE LOG SPLITTER DETENT VALVE	1
8	644825 CYLINDER ASSEMBLY	3000 PSI 3" BORE X 18" STROKE, DOUBLE ACTING	1
9	14663	PALLET TILTER PUSH PULL CONTROL PANEL WELDMENT	1
10	644825 CYLINDER ASSEMBLY	3000 PSI 3" BORE X 18" STROKE, DOUBLE ACTING	1
11	HEX BOLT GRADE 8_~750-10 UNC_3~5_SIMP	HEX BOLT 3/4-10 X 3-1/2" GRADE 8	4
12	HEX NUT_~375-16 UNC_0_LOCK	NYLOCK NUT 3/8-16	6
13	HEX BOLT_~375-16 UNC_5_SIMP	HEX BOLT 3/8-16 X 5" GRADE 5	4
14	WSHR A_~375N	WASHER 3/8 N	2
15	HEX BOLT_~375-16 UNC_1_SIMP	HEX BOLT 3/8-16 X 1"	2



# AZTECH CONVERTING SYSTEMS

PT-2000  
USER MANUAL

## Section 6: Warranties and Service

### 6-1: Warranties & Provisions

**WARRANTIES:** All equipment manufactured and sold by AZTECH Converting Systems (Seller) is warranted to be free of defective materials and workmanship under normal use and service for a period of one (1) year from the date of delivery to Buyer's premises. All commercial components not manufactured by Seller carry the original manufacturer's warranty. At Seller's discretion, Seller may provide on-site warranty service for a period of ninety (90) days from the aforementioned date.

**REMEDIES** If within the Warranty Period any such Equipment is proven to Seller's satisfaction to be defective in either material or workmanship, Seller, at its sole discretion, shall (a) repair or replace defective parts on the Equipment at Seller's cost, or (b) grant a reasonable allowance on account of such a breach. If within the Warranty Period the Seller receives notice from Buyer of defects in parts or materials. Seller will ship (ground, prepaid) replacement parts) and invoice Buyer for the full cost of the replacement parts). Buyer will receive a Return Authorization (RA) from seller, and return defective parts or materials to Seller, who at its sole discretion shall determine whether defective parts or materials are or are not subject to exclusion from this warranty as provided herein. Any defective parts or material not excluded from the Warranty Period will then be fully credited to Buyer.

### EXCLUSIONS

#### THE FOLLOWING ITEMS ARE EXCLUDED FROM THIS WARRANTY:

- Defects or damage caused by careless or improper use.
- Parts that need periodic replacement from wear during normal operation.
- Routine maintenance and adjustment.
- Failure or damage caused by improper installation or inadequate maintenance by Buyer.
- Failure or damage caused by equipment modifications by Buyer.
- Equipment damage resulting from an accident, or abnormal conditions of operation.

### DISCLAIMER OR WARRANTY

**NO OTHER WARRANTY IS EXPRESSED OR IMPLIED INCLUDING WARRANTIES OF MERCHANTABILITY AND FITNESS FOR ANY PARTICULAR PURPOSE. SELLER IS NOT LIABLE FOR INCIDENTAL OR CONSEQUENTIAL DAMAGE SUCH AS, BUT NOT LIMITED TO LOSS IN PROFITS, LOSS OF USE OF EQUIPMENT, OR INCREASED IN OPERATING COSTS OR EXPENSES.**

### 6-2: Technical Service

In the event that your machine is not functioning properly or if you have any technical questions, an AZTECH Technical Service representative is available to assist you. Contact information is as follows:

**Phone:** 1-480-951-8351  
1-800-829-8351  
**Fax:** 1-480-998-5409  
**E-Mail:** [techservice@aztechconverting.com](mailto:techservice@aztechconverting.com)